

## Fastener Categories

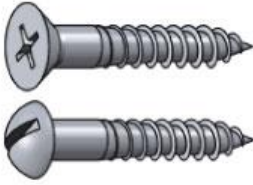

### Wood Screws

Screws with a smooth shank and tapered point for use in wood. Abbreviated WS



### Machine Screws

Screws with threads for use with a nut or tapped hole. Abbreviated MS

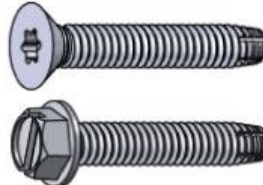

### Thread Cutting Machine Screws

Machine screws with a thread cutting (self tapping) point.

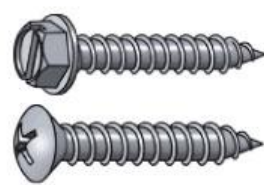

### Sheet Metal Screws

Fully threaded screws with a point for use in sheet metal. Abbreviated SMS

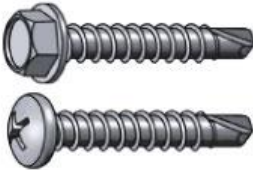

### Self Drilling SMS

A sheet metal screw with a self drilling point.

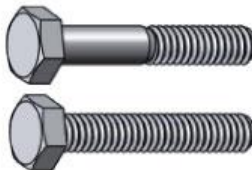

### Hex Bolts

Bolts with a hexagonal head with threads for use with a nut or tapped hole. Abbreviated HHMB or HXBT.



### Carriage Bolts

Bolts with a smooth rounded head that has a small square section underneath.



### Lag Bolts

Bolts with a wood thread and pointed tip. Abbreviated Lag.



### Socket Screws

Socket screws, also known as Allen Head, are fastened with a hex Allen wrench.



### Set Screws

Machine screws with no head for screwing all the way into threaded holes.



### Eye Bolts

A bolt with a circular ring on the head end. Used for attaching a rope or chain.



### Eye Lags

Similar to an eye bolt but with wood threads instead of machine thread.



### J-Bolts

J shaped bolts are used for tie-downs or as an open eye bolt.



### U-Bolts

Bolts in U shape for attaching to pipe or other round surfaces. Also available with a square bend.



### Shoulder Bolts

Shoulder bolts (also known as stripper bolts) are used to create a pivot point.



### Elevator Bolts

Elevator bolts are often used in conveyor systems. They have a large, flat head.

## Fastener Categories *(continued)*



### Sex Bolts

Sex bolts (a.k.a. barrel nuts or Chicago bolts) have a female thread and are used for through bolting applications where a head is desired on both sides of the joint.



### Mating Screws

Mating screws have a shoulder that matches the diameter of the sex bolts they are used with.



### Hanger Bolts

Hanger bolts have wood thread on one end and machine thread on the other end.

## Head Styles



### Flat

A countersunk head with a flat top.  
Abbreviated FH



### Oval

A countersunk head with a rounded top.  
Abbreviated OH or OV

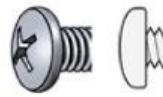

### Pan

A slightly rounded head with short vertical sides.  
Abbreviated PN



### Truss

An extra wide head with a rounded top.



### Round

A domed head.  
Abbreviated RH

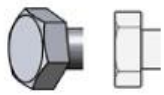

### Hex

A hexagonal head  
Abbreviated HH or HX



### Hex Washer

A hex head with built in washer.



### Slotted Hex Washer

A hex head with built in washer and a slot.



### Socket Cap

A small cylindrical head using a socket drive.



### Button

A low-profile rounded head using a socket drive.